

BEA 050/250/350/450/840/850

Introduction of Andros-measuring chamber

From FD 2007-07 onwards, the BEA is equipped with the Andros measuring chamber. All the functions of the BEA remain as they were; the Andros measuring chamber is structurally smaller as compared to its predecessor and is easier to maintain.

An overview of the purchase order numbers for add-on kits and replacement parts:

Description	Purchase order number for Siemens-measuring chamber	Purchase order number for Andros-measuring chamber
Measuring chamber	1 685 115 147 1 682 666 003 (Replacement)	1 685 115 154 1 682 666 310 (Replacement)
AMM	1 687 022 768 - - -	1 687 001 881 1 682 666 309 (Replacement)
BEA 050	0 684 105 050	0 684 105 051
NRS gasoline for BEA 150 up to BEA 350	1 687 001 506	1 687 001 866
NRS gasoline for BEA 110 up to BEA 810	1 687 001 576	1 687 001 865

Replacement of a Siemens-measuring chamber within the **warranty** period

If a Siemens measuring chamber breaks down within the warranty period, then a Siemens-measuring chamber **1 682 666 003** has to be ordered and installed.

Repair of a Siemens-measuring chamber

In case of repairs, not the Siemens-measuring chamber but the installed exhaust-gas measuring module 1 687 022 768 (AMM including the Siemens-measuring chambers) have to be replaced with the new AMM **1 682 666 309**. The AMM 1 682 666 309 contents the Andros measuring chamber 1 685 115 154, which is actual not supported in all countries. Please check your software, if it supports the Andros measuring chamber, see „**Gesamtübersicht aller Software-Versionen**“ in EDIS.

 The replacement kit NO 1 687 001 504 can be upgraded without any modifications in case of Andros-measuring chamber.

AMM with Siemens-measuring chamber

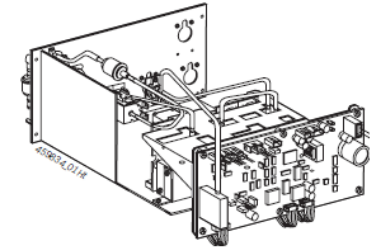

Siemens-measuring chamber

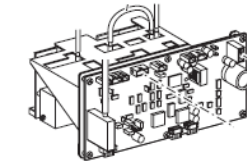

AMM mit Andros-measuring chamber

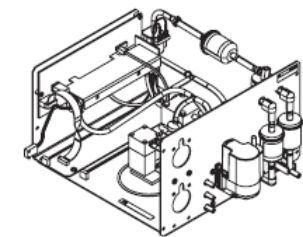

Andros-measuring chamber

